

How to add a machine

Machines can be added to your pre start plus app two ways -

1. Your existing machines in Plant Assessor can be easily added to pre start plus in a few simple steps. **LOGIN** to Plant Assessor and add the machines you wish to appear in your pre start list to your favourites list. To do this, find the machine, click **EDIT**, check the yellow star at the top right of the screen the click **SAVE**. This machine will now appear in your pre start plus app.

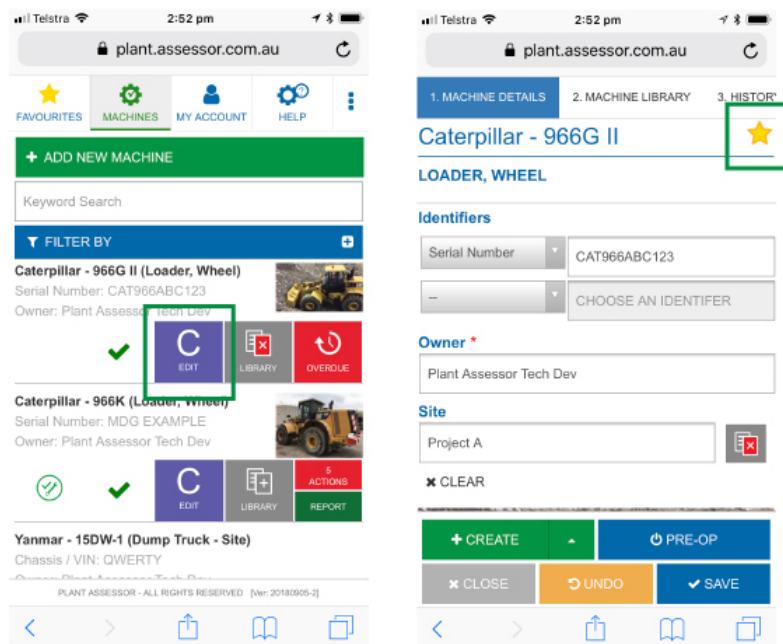

NOTE: your pre start plus login gives your access to Plant Assessor Free - [login here](https://plant.assessor.com.au/PlantAssessor/Account/Login) (<https://plant.assessor.com.au/PlantAssessor/Account/Login>) and start managing your fleet, sites and operators.

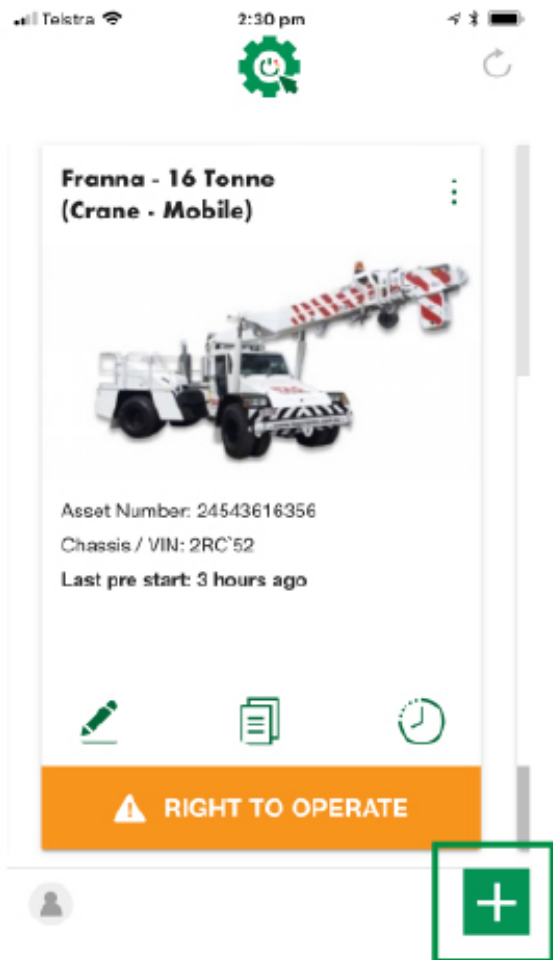

2. To add a NEW machine in pre start plus click the green plus button at the bottom right of the screen. Complete the make, model & identifier fields then click **CREATE NEW MACHINE**. Add in subsequent information such as a site, hour meter and photo, then click **SAVE**.

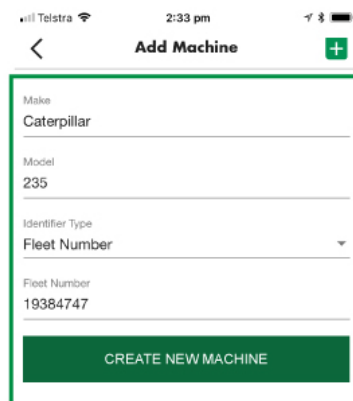
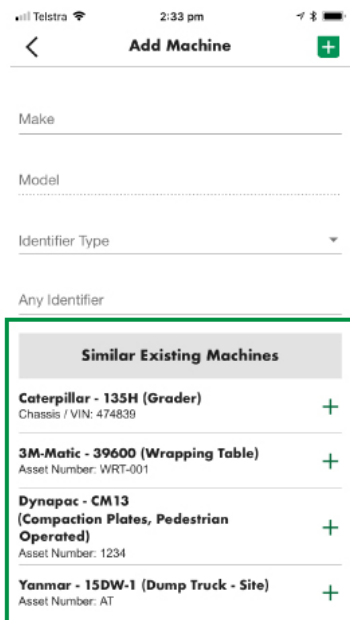

TIP: To avoid adding duplicate machines a list of similar existing machines is included at the bottom of the screen. This includes all your machines in Plant Assessor.